

# General Information

## A. Registration

1. For those who paid by online registration and received a ID badge, please fill the ID badge and bring it to the meeting. If you forget to bring it, come to the Registration desk with your ID.

2. For on-site registration, please come to registration desk and pay registration fee (see below) and get a ID badge.

Registration fee does not include the proceedings.

On Site Registration Fee

Member: JPY 14,000

Member, Student: JPY 3,000

Non-member: JPY 18,000

Non-member, Student: JPY 5,000

3. For Honorary and Distinguished members, please come to the General Information at the Registration desk (Exhibition Hall) .

4. Registration desk is open in the following hours:

Tuesday, December 12: 7:30-16:30

Wednesday, December 13: 7:15-16:00

Thursday, December 14: 7:15-16:00

## B. Application and Annual Membership Fee

1. For those who want to join the JSI, please come to the JSI desk (Exhibition Hall) .

Application Fee: JPY 1,000

Annual Membership Fee

Member (Domestic) : JPY 11,000

Member (Overseas) : JPY 12,000

Student Member (Domestic) : JPY 3,000

Student Member (Overseas) : JPY 4,000

2. Please note that cash only for payment at the JSI desk.

## C. Program Book, Proceedings

We changed it as you read in a member exclusive page of the home page of JSI using your member number (the ID) and password about Proceedings from fiscal year 2018.

We'll open it in sequence annual meeting home page of JSI as well as distribute a paper medium at the meeting site about a program.

We prepared in order to read proceedings on the web by a charge (JPY 5,000) to everybody of a non-member, so please come to the JSI secretariat desk.

## D. Council Meeting

12:00-13:00, Dec. 12 / Room C

## E. The General Assembly, Ceremonies & Lectures

11:15-11:45, Dec. 13 / Room A

Ceremonies and Lectures as given below will be held after the General Assembly in Room A on Dec. 13.

- Commendation Ceremony for JSI Meritorious Members
- JSI Award Ceremony and Lecture
- JSI Human Immunology Research Award Ceremony and Lecture
- JSI Women Immunologist Award Ceremony and Lecture
- JSI Young Investigator Award Ceremony
- "Kibou Projects" Scholarship for Doctoral Students in Immunology Winners Introduction
- Tadimitsu Kishimoto International Travel Award Winners Introduction
- Ursula and Fritz Melchers Travel Award Winners Introduction

## **F. Symposia**

Scheduled is twelve sessions (S1-S12) by international speakers. For further information, see the program.

## **G. Poster and Workshop**

All the papers are presented in poster session. Presentations in workshops are selected from the papers.

The language for presentation and discussion is English.

During poster session beverages will be served.

## **H. Overview Talks**

Overview talks selected topics for students and those who are not specialized in the topics. Overview talks pick up a topic related to the following symposium session.

## **I. Seminar Ticket (include Lunch box)**

1. You can enjoy lunch box during the seminars and Lecture scheduled in lunch time. To get lunch box, you need to come to the Seminar ticket desk which is next to the registration desk and get a ticket beforehand. You need to have ID badge to get a ticket.

December 12: 7:45-11:00 (After 11:20, you may get Seminar ticket in front of each room if Seminar ticket is still left.)

December 13: 7:15-12:10 (After 12:30, you may get Seminar ticket in front of each room if Seminar ticket is still left.)

December 14: 7:15-10:30 (After 10:50, you may get Seminar ticket in front of each room if Seminar ticket is still left.)

2. With a ticket, you can get lunch box in front of a room for the seminar you choose after the following time.

December 12: 11:30-

December 13: 12:40-

December 14: 11:00-

## **J. Seminars**

■ International Immunology Luncheon Seminar

■ Technical Seminar

■ Clinical Seminar

Lunch box is available for you. To obtain Lunch box, see above.

## **K. Exhibition**

Exhibition, Wireless LAN, and Drink Service are available at the Exhibition Hall.

## **L. Get Together Party**

Date & Time: 17:30-19:30, December 13 (Wed.), 2017

Venue: Sakura Hall, Sendai International Center 2F

Participation Fee (On-site)

Regular Member JPY 4,000

Student Member JPY 2,000

Non-member JPY 4,000

Non-member (Student) JPY 4,000

## **M. Photographing and recording**

Photographing and recording is prohibited in symposia, workshops, and poster sessions. Please understand our policy, which helps presentation and discussion to be hot.

# FLOOR PLAN

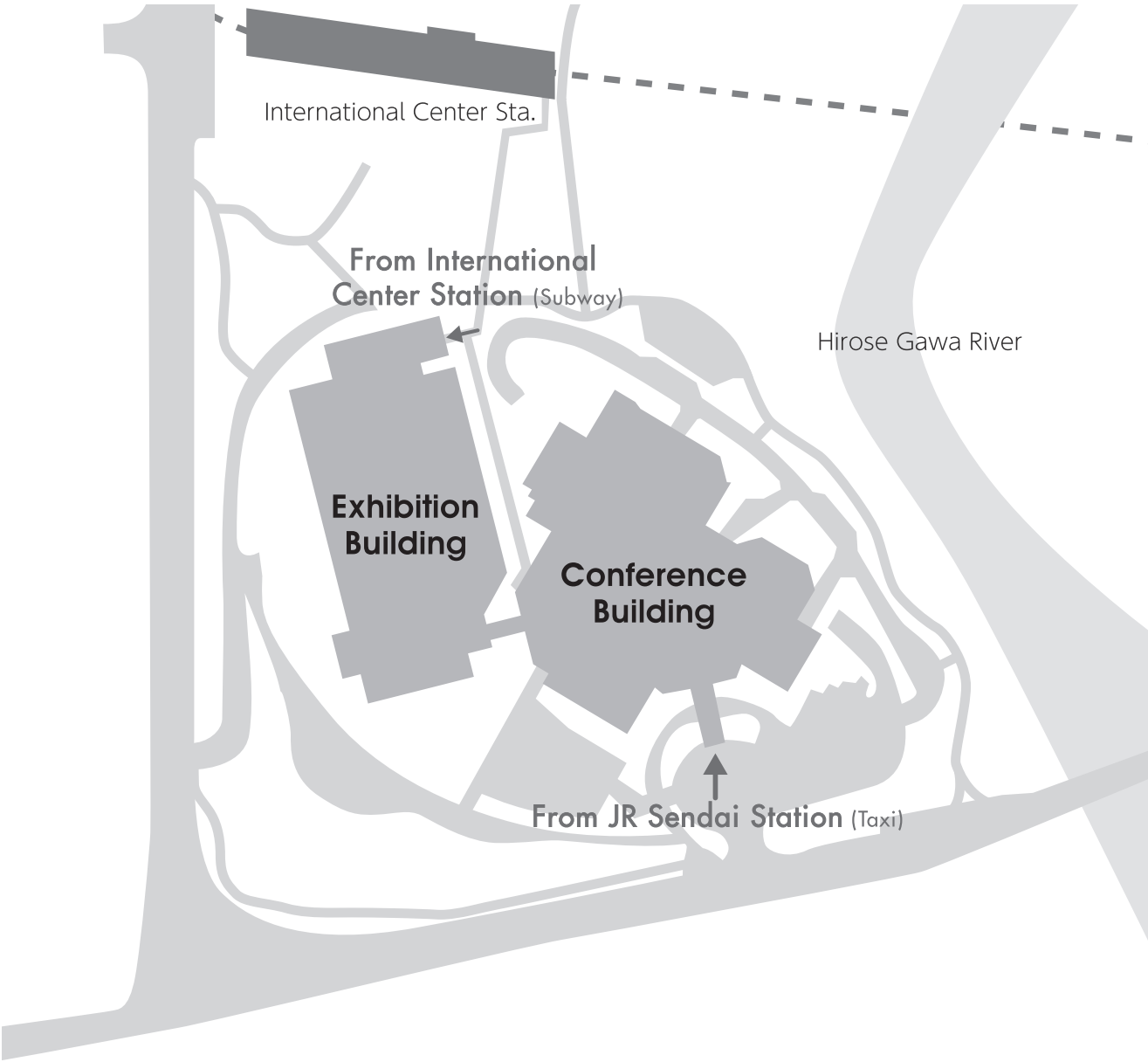

2F Conference building

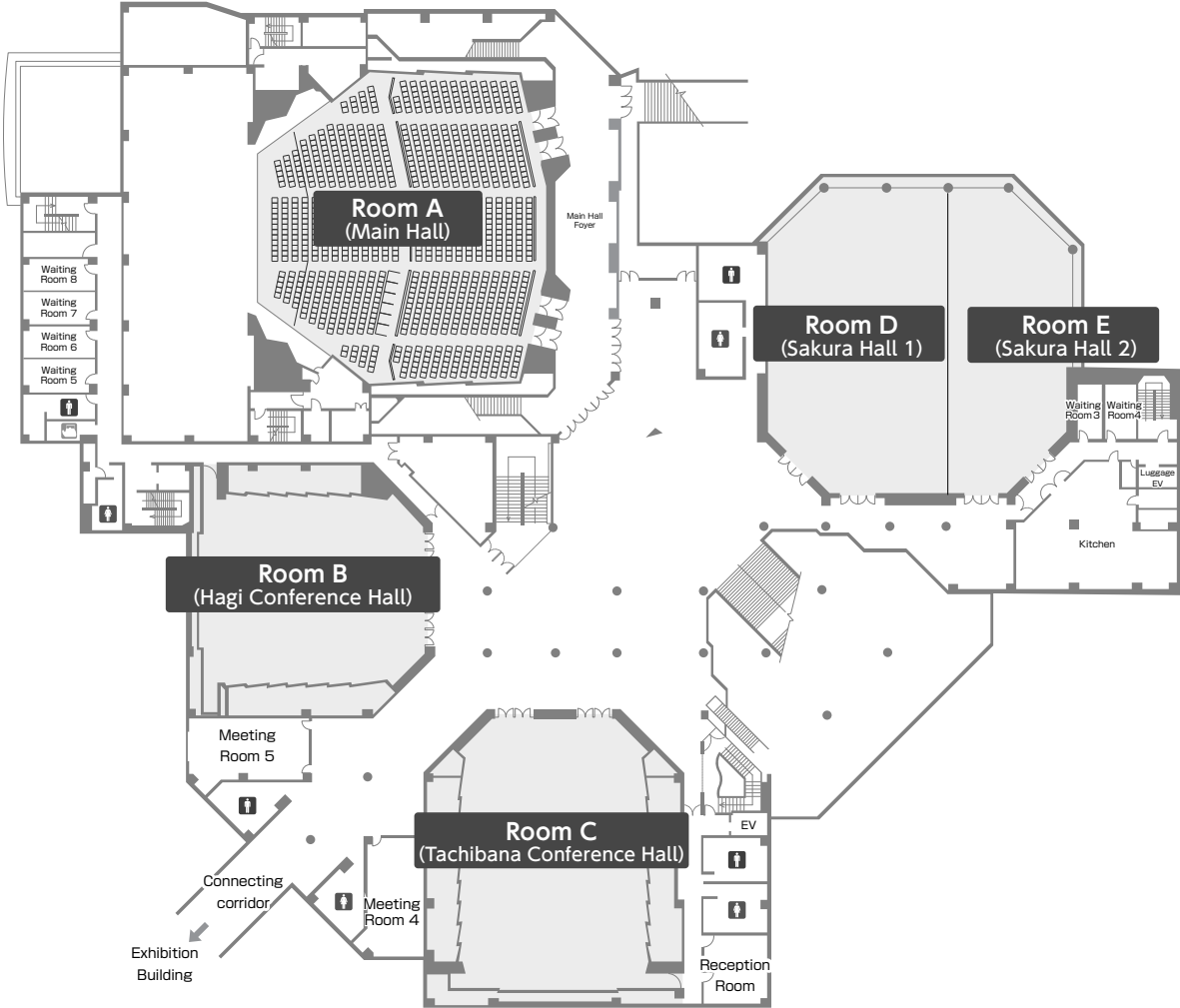

# FLOOR PLAN

## 3F Conference building

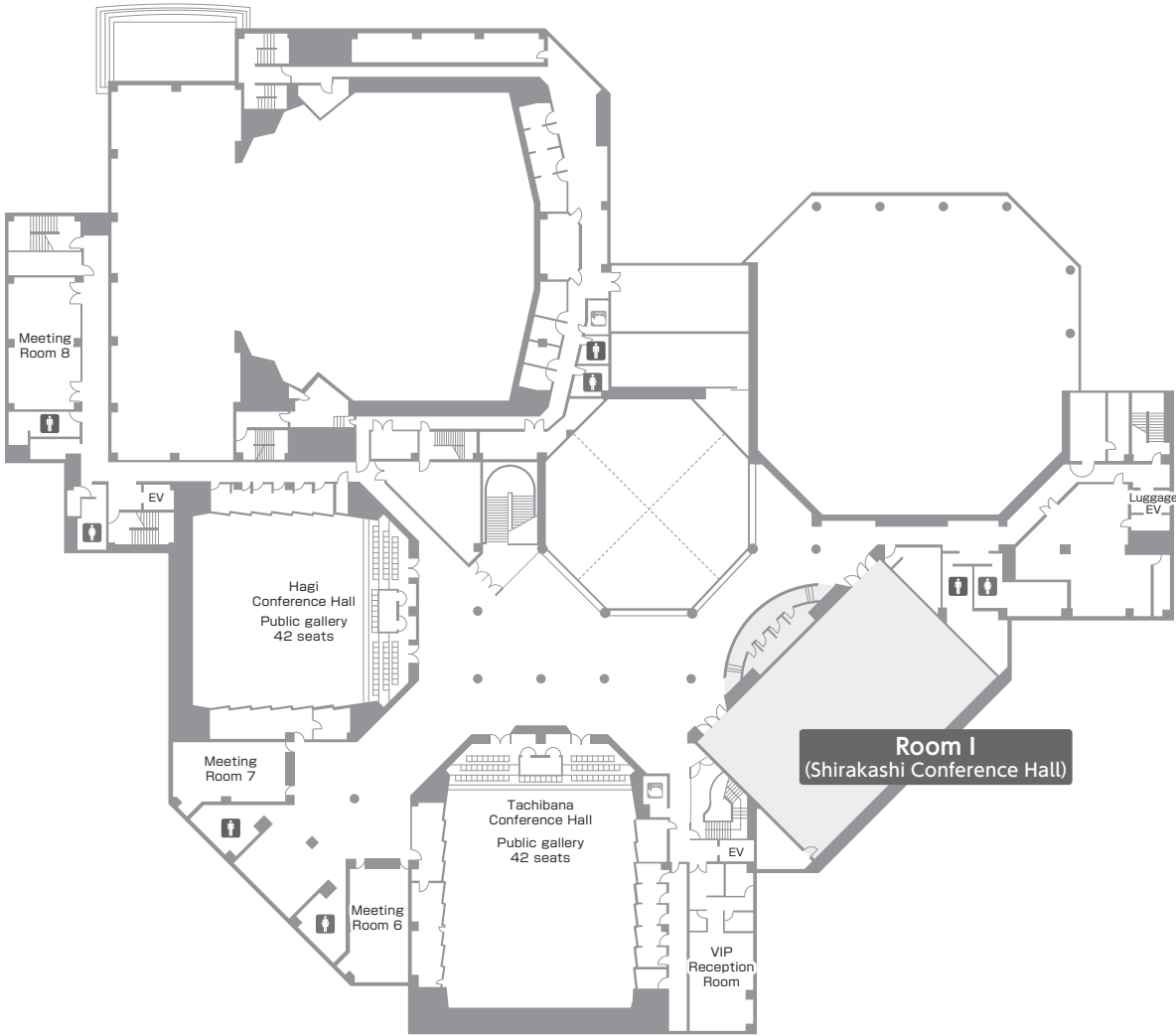

## 2F Exhibition building

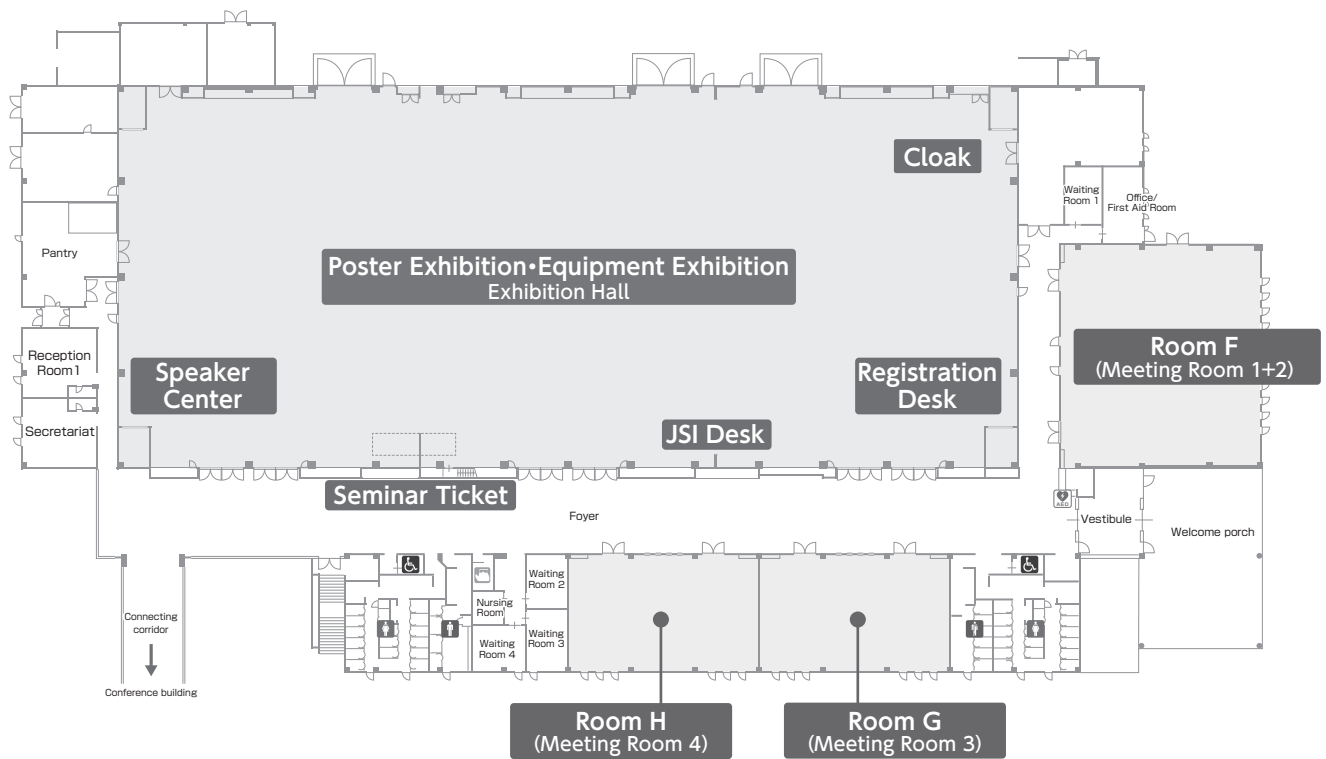

# The 46th Annual Meeting of The Japanese Society for Immunology Schedule

## December 12 (Tue.)

Overview Talk (オーバービュートーク)	8 : 30 ~ 9 : 00	Room A, B, C, D
Symposium	9 : 00 ~ 11 : 30	Room A, B, C, D
Poster Exhibition, Discussion	8 : 30 ~ 18 : 30	Exhibition Hall
Equipment Exhibition	10 : 00 ~ 18 : 30	Exhibition Hall
Technical Seminar	12 : 00 ~ 13 : 00	Room D, E, F, G, H, I
Council Meeting	12 : 00 ~ 13 : 00	Room C
Workshop	13 : 20 ~ 16 : 15	Room A, B, C, D, E, F, G, H, I

## December 13 (Wed.)

Overview Talk (オーバービュートーク)	8 : 00 ~ 8 : 30	Room A, B, C, D
Symposium	8 : 30 ~ 11 : 00	Room A, B, C, D
Poster Exhibition, Discussion	8 : 30 ~ 17 : 00	Exhibition Hall
Equipment Exhibition	10 : 00 ~ 17 : 00	Exhibition Hall
Technical Seminar	13 : 10 ~ 14 : 10	Room G, H, I
Clinical Seminar	13 : 10 ~ 14 : 10	Room B, C, F
General Assembly & Award Lecture	11 : 15 ~ 12 : 55	Room A
Workshop	14 : 25 ~ 15 : 45	Room A, B, C, F, G, H, I

## December 14 (Thu.)

Overview Talk (オーバービュートーク)	8 : 00 ~ 8 : 30	Room A, B, C, I
Symposium	8 : 30 ~ 11 : 00	Room A, B, C, I
Poster Exhibition, Discussion	8 : 30 ~ 18 : 00	Exhibition Hall
Equipment Exhibition	10 : 00 ~ 18 : 00	Exhibition Hall
International Immunology Luncheon Seminar	11 : 30 ~ 12 : 30	Room H
Technical Seminar	11 : 30 ~ 12 : 30	Room E, G
Clinical Seminar	11 : 30 ~ 12 : 30	Room D, F, I
Workshop	12 : 50 ~ 15 : 45	Room A, B, C, D, E, F, G, H, I

December 12 (Tue.), 2017

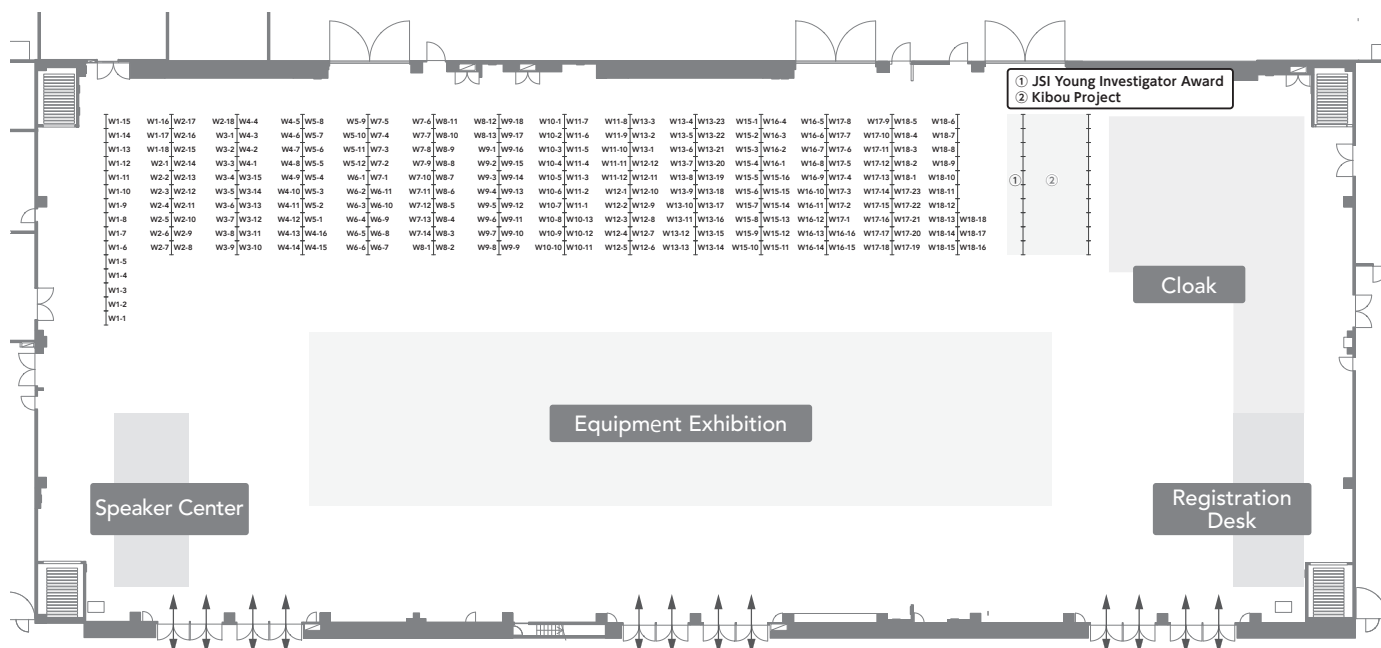

WS	WS Title	Poster
W1	Allergy-1 : Lower airway allergic inflammation	W1-1~W1-18
W2	Allergy-2 : Upper airway allergic inflammation and allergic responses	W2-1~W2-18
W3	Endogenous innate immunity and inflammation-1	W3-1~W3-15
W4	Endogenous innate immunity and inflammation-2	W4-1~W4-16
W5	Tissue-specific immune diseases I	W5-1~W5-12
W6	Tissue-specific immune diseases II	W6-1~W6-11
W7	Virus infection-1	W7-1~W7-14
W8	Virus infection-2	W8-1~W8-13
W9	Immune response to bacterial infections	W9-1~W9-18
W10	Immune response to mycobacterial and fungal infections	W10-1~W10-13
W11	Combination cancer immunotherapy -beyond immune checkpoint inhibitors-	W11-1~W11-12
W12	Immune responses in cancer immunotherapy	W12-1~W12-12
W13	Hematopoiesis and immune environments	W13-1~W10-23
W15	Cytokines and chemokines-1	W15-1~W15-16
W16	Cytokines and chemokines-2	W16-1~W16-16
W17	Human Immunology	W17-1~W17-23
W18	Helper T cells	W18-1~W18-18



December 13 (Wed.), 2017

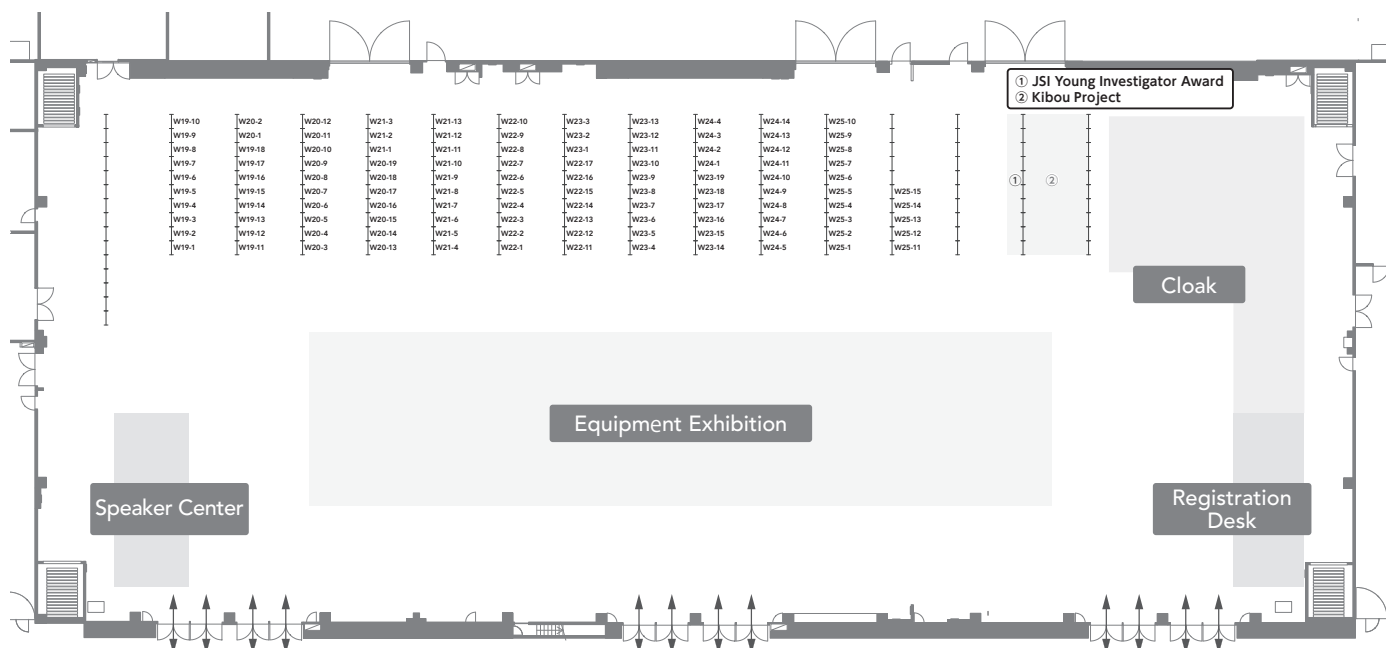

WS	WS Title	Poster
W19	Mucosal-Skin Immunity-1	W19-1~W19-18
W20	Systemic autoimmune disease (1)	W20-1~W20-19
W21	Cancer Cell Therapy	W21-1~W20-13
W22	T cell-1 : T cell development and repertoire selection	W22-1~W22-17
W23	Allergy-3 : Allergic dermatitis, food allergy and allergic conjunctivitis	W23-1~W23-19
W24	Immune response to parasite infections	W24-1~W24-14
W25	Dendritic cells and Macrophages-1: Organ-specific Immune Tolerance	W25-1~W25-15

December 14 (Thu.), 2017

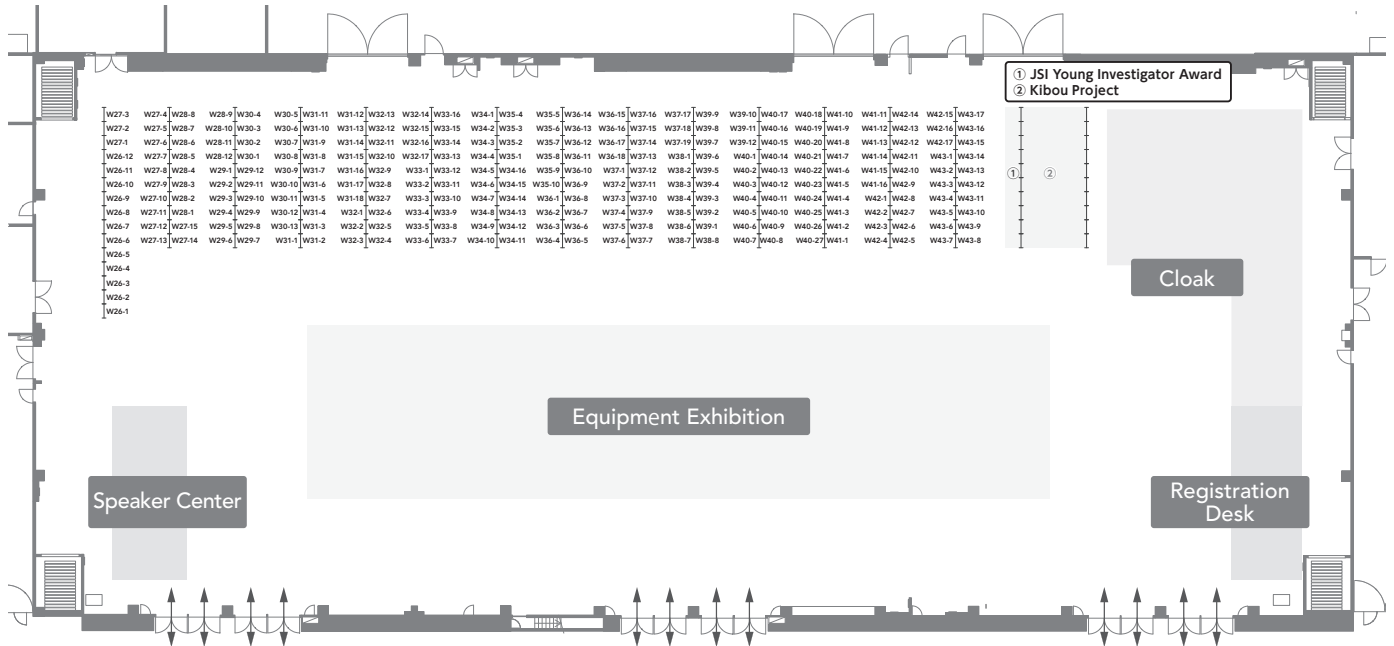

WS	WS Title	Poster
W26	Tolerance and immune suppression-1	W26-1~W26-12
W27	Tolerance and immune suppression-2	W27-1~W27-15
W28	Innate Lymphocyte-1 (NKT, MAIT, gdT, NK)	W28-1~W28-12
W29	Innate Lymphocyte-2 (ILC1,2,3)	W29-1~W29-12
W30	Dendritic cells and Macrophages-2 : Development and Recognition	W30-1~W30-13
W31	Dendritic cells and Macrophages-3 : Inflammatory Responses	W31-1~W31-18
W32	Tumor immunology-1 (Tumor antigens, antigen presenting cells, anti-tumor T cells)	W32-1~W32-17
W33	Tumor immunology-2 (Immunosuppression and modulation in tumor immunity)	W33-1~W30-16
W34	B cell development and function	W34-1~W34-16
W35	Germinal center reaction and plasma cells	W35-1~W35-10
W36	Mucosal-Skin Immunity-2	W36-1~W36-18
W37	Mucosal-Skin Immunity-3	W37-1~W37-19
W38	Systemic autoimmune disease (2)	W38-1~W38-8
W39	Systemic autoimmune disease (3)	W39-1~W39-12
W40	Granulocyte & Mast cells	W40-1~W40-27
W41	Tissue-specific immune diseases III	W41-1~W41-16
W42	T cell-2 : T cell signaling	W42-1~W42-17
W43	T cell-3 : T cell function	W43-1~W43-17